

MITCHELL & BROWN

Quick Start Guide

JB-321811F

Customer Helpline: 01204 377693

1 Insert the batteries into the Remote Control

Insert two **AAA/R3** or equivalent type batteries inside. Observe the correct polarity (+/-) when inserting batteries and replace the battery cover.

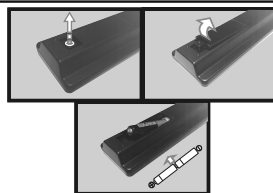

2 Connect the antenna to your TV

REAR SIDE OF THE TV

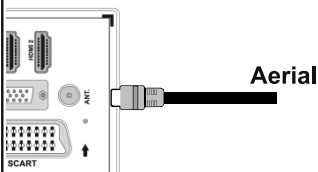

3 Connect the TV to the mains socket

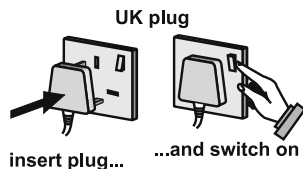

4 To switch the TV on

Connect the power cord to a power source such as a wall socket (220-240V AC, 50 Hz).

To switch on the TV from standby mode either:

Press the "⏻" button, **Programme +/-** or a numeric button on the remote control.

Press the side function switch on the TV until the TV comes on from standby.

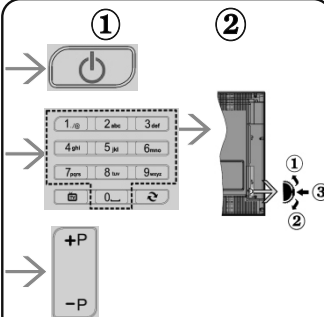

5 HDMI input

PLEASE ENSURE BOTH UNITS ARE SWITCHED OFF BEFORE CONNECTING. Use a HDMI to HDMI cable to connect the two units together. To select the HDMI input, press the **Source** button on the remote control. Each time it is pressed the on-screen menu confirms your selection.



To HDMI connection
on the device



6 Auto Setup procedure

When turned on for the first time, the language selection screen is displayed. Select the desired language and press **OK**.

On the next screen, set your preferences using the directional buttons.

Note: Depending on the **Country** selection you may be asked to set and confirm a PIN at this point. The selected PIN cannot be 0000. You have to enter it if you are asked to enter a PIN for any menu operation later.

About Selecting Broadcast Type

Digital Aerial: If aerial broadcast search option is turned on, the TV will search for digital terrestrial broadcasts after other initial settings are completed.

Additionally you can set a broadcast type as your favourite one. Priority will be given to the selected broadcast type during the search process and the channels of it will be listed on the top of the **Channel List**. When finished, press **OK** to continue.

You can activate **Store Mode** option at this point. This option is intended only for store use. It is recommended to select **Home Mode** for home use.

Press **OK** button on the remote control to continue and the **Network Settings** menu will be displayed. Please refer to the next section about internet connection on the next page to configure a wired or a wireless connection. After the settings are completed press **OK** button to continue.

After the initial settings are completed TV will start to search for available broadcasts of the selected broadcast types. The **Edit Channel List** menu will be displayed when the search is completed. You can edit the channel list according to your preferences or press the **Menu** button to quit and watch TV.

While the search continues a message may appear, asking whether you want to sort channels according to the LCN(*). Select Yes and press **OK** to confirm.

(* LCN is the Logical Channel Number system that organizes available broadcasts in accordance with a recognizable channel number sequence (if available).

Note: Do not turn off the TV while initializing first time installation. Note that, some options may not be available depending on the country selection.



50381094